

Proposed Discretionary Use

MUNICIPAL ADDRESS

5631 44 Street
Lloydminster, AB

Date: 05/11/2026

File No.: 26-5912

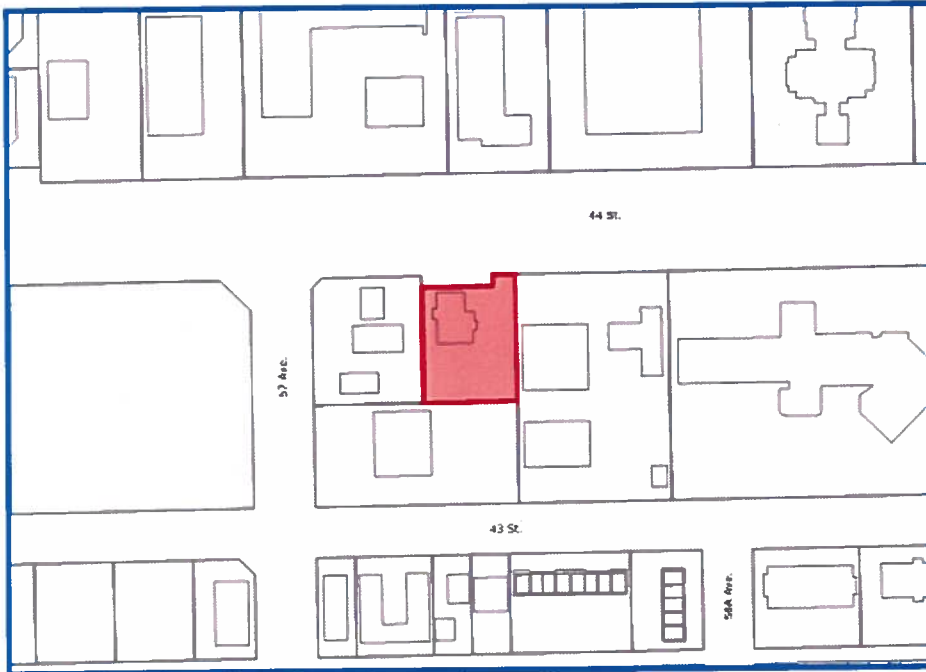

 Subject Lands

 Existing Building

 Legal Parcel

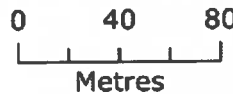

Tell Us What You Think

Please submit any comments, concerns, or support surrounding this proposed development in writing to Planning Services no later than **05/28/2026** to be considered prior to a decision being made.

When submitting please include the following:

Your full name,
Your Municipal Address,
Reasoning supporting or opposing the development,
Application number

Comments can be submitted by email to:
permits@lloydminster.ca.

Or in person at:
City of Lloydminster Operations Centre
6623 52 Street
Lloydminster, AB, T9V 3T8

This notification is sent to all property owners within 200 m of the address listed to inform nearby residents that Planning Services has received an application for a **Discretionary Use** proposed at the indicated address.

Application Information

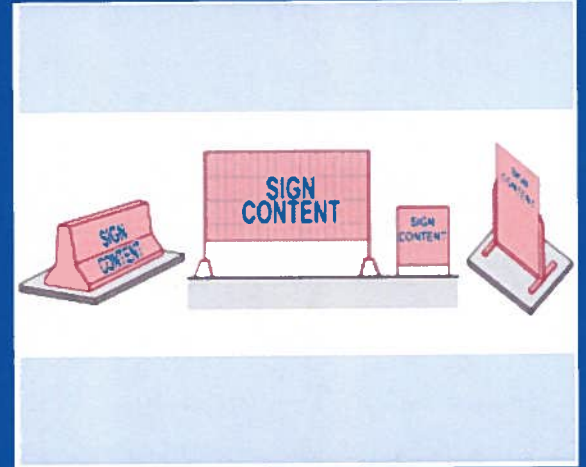

Concept of Proposed Development

Proposed Use:
Portable Sign

Application No.: 26-5912

Applications are reviewed based on the provisions of **Land Use Bylaw 05-2025** along with any planning related concerns submitted.

For more information, contact Planning Services using the contact details below; or scan the QR Code for our website, scroll to *Public Notices, View Current Applications* and look for *Application No.:* 26-5912.



lloydminster.ca/development

Signs - Portable

What type of sign are you applying for?

New Portable Sign

What permit length are you looking to obtain?

three hundred and sixty-five (365) consecutive days

Has the sign been installed already?

No

Do you have an active and valid City of Lloydminster Business Licence?

Yes

Sign Installation Date:

5/8/2026

Sign Removal Date:

5/8/2026

Will the sign be placed wholly on private land?

Yes

Will the sign be placed in an easement or right of way?

No

How many portable signs, not including this proposed sign are on the site?

1

How many metres will the portable sign be from an existing freestanding sign?

10

Will the portable sign be fastened to the ground on a permanent foundation or on top of another structure?

Yes

How many metres will your sign be from the property line?

10

How many metres will your sign be from an access to the site?

10

What is sign area? (one side only)

10

What is the height of the sign? (grade to top of sign)

10

Is the site in which you are proposing to place the Portable Sign a corner lot?

No

Property Address (Where sign is being installed)

5631-44 Street

Signs - Portable

Lot Number:

2

Plan Number:

762-1667

Tax Roll Number

22160290000

Land Use District (Zoning)

CC



Are you the landowner listed on the Land Title?

Yes

Are you the sign owner?

Yes

Who is Paying the Application Fees?

Applicant

Please provide a detailed description of the project/proposed work and the sign.

1 portable Sign

I understand that this is only an application and I cannot place portable signs without obtaining development approval first.

Signs - Portable

Yes

I declare that I will notify the City of any proposed changes to the information provided including proposed location submitted with this application.

Yes

I consent to receiving notifications & correspondence regarding this application via email unless otherwise specified by the applicant in writing.

Yes

I am aware, that if I am not the landowner listed on the land title, a copy of this application and decision may be provided by our office to the landowner for their records.

Yes



5633 44 St

Portable Sign

