

## Proposed Discretionary Use

### MUNICIPAL ADDRESS

2101 50 Avenue  
Lloydminster, SK

Date: 04/20/2026  
File No.: 26-5832

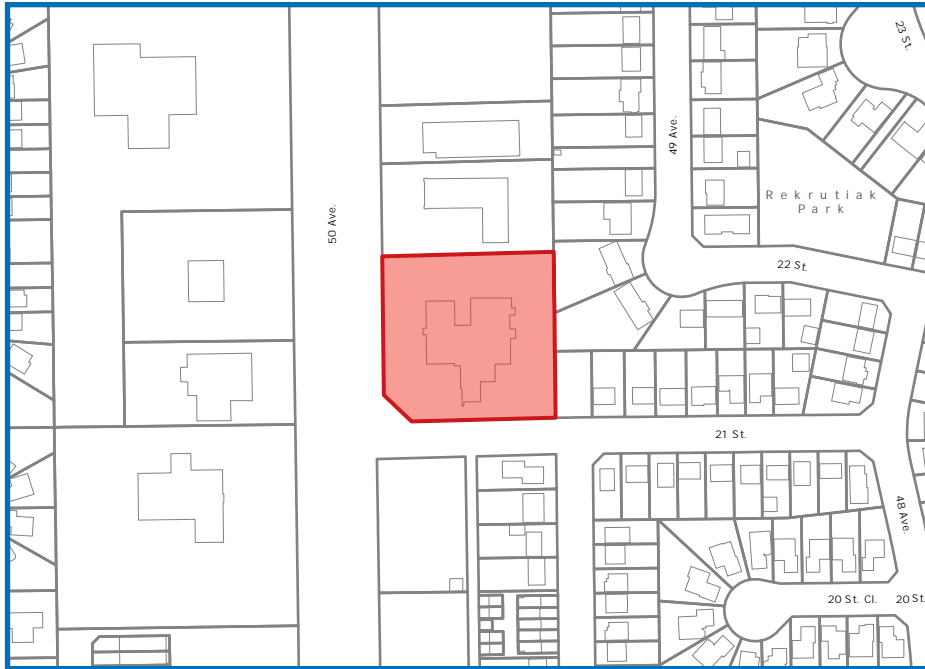

- Subject Lands
- Existing Building
- Legal Parcel

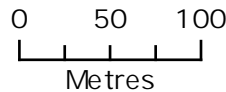

## Tell Us What You Think

Please submit any comments, concerns, or support surrounding this proposed development in writing to Planning Services no later than 05/07/2026 to be considered prior to a decision being made.

When submitting please include the following:

- Your full name,
- Your Municipal Address,
- Reasoning supporting or opposing the development,
- Application number

Comments can be submitted by email to:  
[permits@lloydminster.ca](mailto:permits@lloydminster.ca).

Or in person at:  
City of Lloydminster Operations Centre  
6623 52 Street  
Lloydminster, AB, T9V 3T8

This notification is sent to all property owners within 200 m of the address listed to inform nearby residents that Planning Services has received an application for a Discretionary Use proposed at the indicated address.

## Application Information

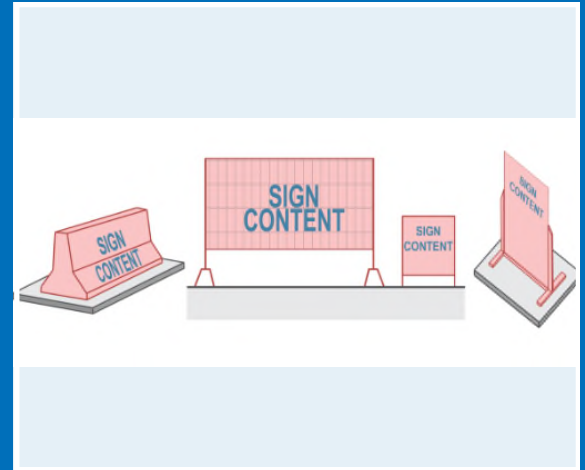

Concept of Proposed Development

Proposed Use:  
Portable Sign

Application No.: 26-5832

Applications are reviewed based on the provisions of Land Use Bylaw 05-2025 along with any planning related concerns submitted.

For more information, contact Planning Services using the contact details below; or scan the QR Code for our website, scroll to Public Notices, View Current Applications and look for Application No.: 26-5832.



[lloydminster.ca/development](http://lloydminster.ca/development)

## Signs - Portable

**What type of sign are you applying for?**

New Portable Sign

**What permit length are you looking to obtain?**

three hundred and sixty-five (365) consecutive days

**Has the sign been installed already?**

No

**Do you have an active and valid City of Lloydminster Business Licence?**

Yes

**Sign Installation Date:**

4/20/2026

**Sign Removal Date:**

4/20/2027

**Will the sign be placed wholly on private land?**

Yes

**Will the sign be placed in an easement or right of way?**

No

**How many portable signs, not including this proposed sign are on the site?**

0

**How many metres will the portable sign be from an existing freestanding sign?**

5

**Will the portable sign be fastened to the ground on a permanent foundation or on top of another structure?**

No

**How many metres will your sign be from the property line?**

0

**How many metres will your sign be from an access to the site?**

6

**What is sign area? (one side only)**

5x10

**What is the height of the sign? (grade to top of sign)**

6

**Is the site in which you are proposing to place the Portable Sign a corner lot?**

Yes

**Will the proposed portable sign be a minimum 30 metres from other portable signs on the site?**

Yes

\$250.00  
26-5832  
20260247  
1136241

## Signs - Portable

---

**How many metres will the sign be from corner intersection?**

6

**Property Address (Where sign is being installed)**

2101 50 avenue

**Lot Number:**

7

**Block Number:**

24

**Plan Number:**

101921060

**Tax Roll Number**

**Land Use District (Zoning)**

CC

**E-mail address**

**Are you the landowner listed on the Land Title?**

No

**Are you the sign owner?**

Yes

**Who is Paying the Application Fees?**

Sign Owner

---

## Signs - Portable

---

**Please provide a detailed description of the project/proposed work and the sign.**

New sign set up

**I understand that this is only an application and I cannot place portable signs without obtaining development approval first.**

Yes

**I declare that I will notify the City of any proposed changes to the information provided including proposed location submitted with this application.**

Yes

**I consent to receiving notifications & correspondence regarding this application via email unless otherwise specified by the applicant in writing.**

Yes

**I am aware, that if I am not the landowner listed on the land title, a copy of this application and decision may be provided by our office to the landowner for their records.**

Yes

---



**The City of Lloydminster**  
Alberta / Saskatchewan  
*Geomatics Services*

**ArcGIS Web Map**

Date 4/17/2026

*No warranty and guarantee is given to the accuracy and completeness of these records. Not for legal purposes, illustrative only.*