

Proposed Discretionary Use

MUNICIPAL ADDRESS

5621 44 Street
Lloydminster, AB

Date: 05/25/2026
File No.: 26-5960

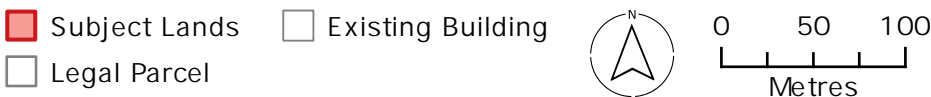
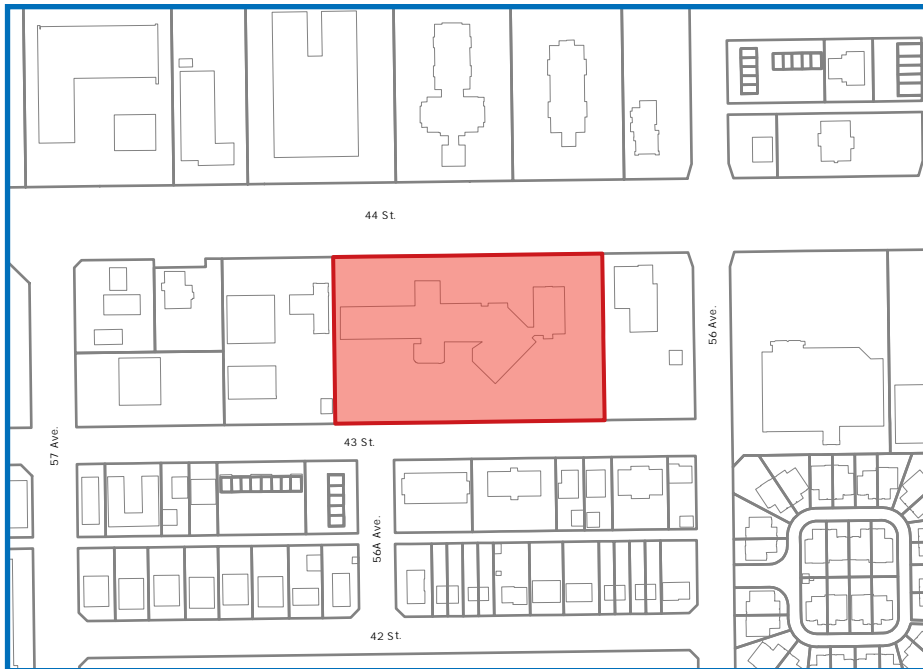

Tell Us What You Think

Please submit any comments, concerns, or support surrounding this proposed development in writing to Planning Services no later than 06/11/2026 to be considered prior to a decision being made.

When submitting please include the following:

- Your full name,
- Your Municipal Address,
- Reasoning supporting or opposing the development,
- Application number

Comments can be submitted by email to:
permits@lloydminster.ca.

Or in person at:
City of Lloydminster Operations Centre
6623 52 Street
Lloydminster, AB, T9V 3T8

This notification is sent to all property owners within 200 m of the address listed to inform nearby residents that Planning Services has received an application for a Discretionary Use proposed at the indicated address.

Application Information

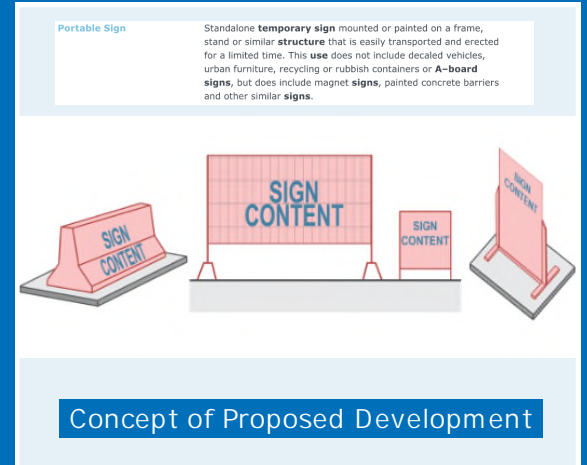

Proposed Use:
An application for Two (2) Portable Signs to be considered for a 1 year permit. Signs will be more than 50 metres apart with one sign being located on the east end of the parking lot along 44 Street and the other being on the west end of the parking lot along 44 Street.

Application No.: 26-5960

Applications are reviewed based on the provisions of Land Use Bylaw 05-2025 along with any planning related concerns submitted.

For more information, contact Planning Services using the contact details below; or scan the QR Code for our website, scroll to Public Notices, View Current Applications and look for Application No.: 26-5960.



lloydminster.ca/development



The City of Lloydminster
Alberta / Saskatchewan
Geomatics Services

ArcGIS Web Map

Date: 5/21/2026

No warrantee and guarantee is given to the accuracy and completeness of these records. Not for legal purposes, illustrative only.

City Note: Two signs are proposed
One sign on east side of property and one on west side along 44 Street; see site plan attached for proposed location.

Signs - Portable

What type of sign are you applying for?

New Portable Sign

What permit length are you looking to obtain?

three hundred and sixty-five (365) consecutive days

Has the sign been installed already?

No

Do you have an active and valid City of Lloydminster Business Licence?

Yes

Sign Installation Date:

5/25/2026

Sign Removal Date:

5/25/2027

Will the sign be placed wholly on private land?

Yes

Will the sign be placed in an easement or right of way?

No

How many portable signs, not including this proposed sign are on the site?

0

How many metres will the portable sign be from an existing freestanding sign?

6

Will the portable sign be fastened to the ground on a permanent foundation or on top of another structure?

No

How many metres will your sign be from the property line?

0

How many metres will your sign be from an access to the site?

5

What is sign area? (one side only)

5x10

What is the height of the sign? (grade to top of sign)

6

Is the site in which you are proposing to place the Portable Sign a corner lot?

No

Property Address (Where sign is being installed)

5621 44ST

Signs - Portable

Lot Number:

2

Block Number:

G

Plan Number:

072.8978

Tax Roll Number

2216000000

Land Use District (Zoning)

CC

[REDACTED]

Are you the landowner listed on the Land Title?

No

Are you the sign owner?

Yes

Who is Paying the Application Fees?

Sign Owner

Please provide a detailed description of the project/proposed work and the sign.

Sign set up

I understand that this is only an application and I cannot place portable signs without obtaining development approval first.